

VARIATION OF ORDER

This Order was varied by Rushmoor Borough Council on the Jul 19, 2022 by a variation order under reference number 403 a copy of which is attached. This order will now be referred to as 403V.

Signed on behalf of Rushmoor Borough Council by

Tim Mills

Tim Mills (Jul 19, 2022 15:15 GMT+1)

Head of Economy, Planning and Strategic Housing

Authorised by the Council to Sign in that behalf

403V SCHEDULE 1

Article 4

SPECIFICATION OF TREES

Trees specified individually
(encircled in black on the map)

Reference on map	Description	Situation
T1	Cedar	Knellwood
T2	Beech	Adj. Knellwood
T3	Oak	Adj. Knellwood
T4	Oak	Adj. Knellwood
T5	Oak	Adj. Knellwood
T6	Oak	Adj. Knellwood
T7	Oak	Adj. Knellwood
T8	Oak	Adj. Knellwood
T9	Oak	Adj. Knellwood
T10	Oak	Adj. Knellwood
T11	Oak	Adj. Knellwood
T13	Oak	Adj. Knellwood
T14	Oak	Adj. Knellwood
T15	Oak	Adj. Knellwood
T16	Oak	Adj. Knellwood
T17	Oak	Adj. Knellwood
T18	Oak	Adj. Knellwood
T19	Oak	Adj. Knellwood
T20	Beech	Knellwood
T21	Horse Chestnut	Knellwood
T22	Horse Chestnut	Knellwood
T23	Sycamore	Adj. 81 Canterbury Road
T24	False Acacia	Adj. 81 Canterbury Road
T25	Oak	Adj. 81 Canterbury Road
T26	Oak	Adj. 81 Canterbury Road
T27	Sycamore	Adj. 81 Canterbury Road
T28	Oak	Adj. 81 Canterbury Road
T29	Oak	Adj. 81 Canterbury Road
T30	Sycamore	Adj. 85 Canterbury Road
T31	Oak	Adj. 85 Canterbury Road
T32	Monkey Puzzle	Adj. 3 King George Close
T33	Oak	Adj. Knellwood
T35	Monkey Puzzle	1 King George Close
T37	Ash	Adj. Knellwood
T38	Sycamore	Adj. Knellwood
T40	Norway Maple	Adj. Knellwood
T41	Oak	King George Close
T42	Oak	King George Close

T43	Scots Pine	Canterbury Gardens
T45	Scots Pine	Adj. Canterbury Gardens
T46	Beech	Adj. Canterbury Gardens
T47	Oak	Adj. Canterbury Gardens
T48	Norway Maple	Adj. Canterbury Gardens
T49	Oak	Adj. Canterbury Gardens
T51	Fir	Adj. Canterbury Gardens
T52	Oak	Adj. Canterbury Gardens
T53	Beech	Adj. Canterbury Gardens
T54	Oak	Adj. Canterbury Gardens
T55	Beech	Adj. Canterbury Gardens

Trees specified by reference to an area
(within a dotted black line on the map)

Reference on map	Description	Situation
	NONE	

Groups of trees
(within a broken line on the map)

Reference on map	Description (including number of trees in the group)	Situation
G1	Oak x 10 Norway Maple x 7 Sycamore x 4 False Acacia x1 Hornbeam x 1	Adj. Knellwood
G2	Oak x 16 Sycamore x 8	152 Sycamore Road

Woodlands
(within a continuous black line on the map)

Reference on map	Description	Situation
	NONE	

TIM MILLS
HEAD OF ECONOMY, PLANNING
AND STRATEGIC HOUSING
COUNCIL OFFICES
FARNBOROUGH ROAD, FARNBOROUGH
HAMPSHIRE
GU14 7JU
TEL: (01252) 398735

TREE PRESERVATION ORDER 403V

Tree Schedule: Please refer to Schedule 1

Location:-
Land affected by TPO 403V
At Sycamore Road, King George Close,
Canterbury Gardens and Canterbury Road
Farnborough
Hampshire

Tim Mills

Tim Mills (Jul 19, 2022 15:15 GMT+1)

Date: 26/04/2022

Scale: 1:1,000

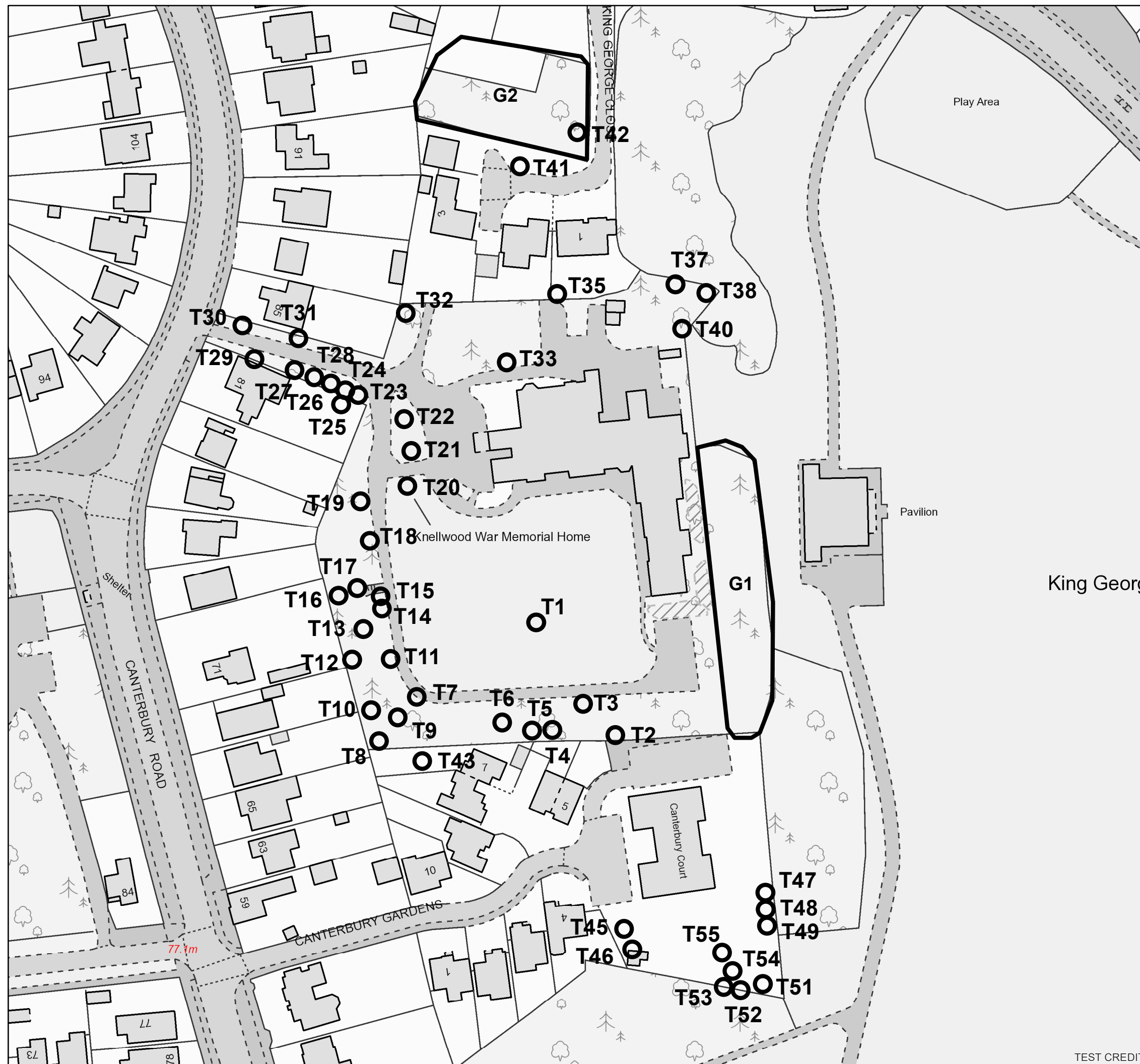
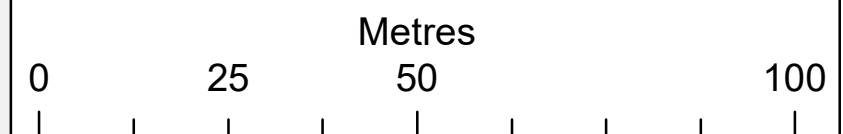

Duplicate

Town and Country Planning Act 1990
TOWN AND COUNTRY PLANNING (TREES) REGULATIONS 1999
TPO 403

**Trees within the grounds and of Knellwood, Canterbury Road,
Canterbury Gardens, King George Close & 152 Sycamore Road,
Farnborough, Hampshire, 2005.**

Rushmoor Borough Council, exercise of the powers conferred on them by sections 198, 201^(a) and 203 of the Town and Country Planning Act 1990 ^(b) and Regulations 1999, hereby make the following Order –

Citation

1. This Tree Preservation Order shall be cited as TPO 403, trees within the grounds of Knellwood, Canterbury Road, Canterbury Gardens, King George Close & 152 Sycamore Road, Farnborough, Hampshire, 2005.

Interpretation

2. In this Order “the authority” means Rushmoor Borough Council and unless the context otherwise requires, any reference in this Order to a number section is a reference to the section so numbered in the Town and County Planning Act 1990.

Application of section 201

3. The authority hereby direct that section 201 (provisional tree preservation orders) shall apply to this Variation Order, and accordingly, this Order shall take effect provisionally on 3rd October 2005

Prohibited acts in relation to trees

4. Without prejudice to subsections (6) and (7) of section 198 (power to make tree preservation order)^(c) or subsection (3) of section 200 (orders affecting land where Forestry Commissioners interested), and subject to article 5, no person shall –

^(a) Under section 199(1), tree preservation orders generally do not take effect until confirmed, but a direction may be given under section 201 for an order to take provisional effect immediately.

^(b) Where the Order is to be made under the sections cited *and* section 300 of the Town and Country Planning Act 1990, all those provisions should be cited, as should the fact of the consent of the appropriate authority. As to the circumstances in which the consent of the Forestry Commission is required (and should be cited) see section 200(1) of that Act.

^(c) Subsection (6) of section 198 exempts from the application of tree preservation orders the cutting down, uprooting, topping or lopping of trees which are dying, dead or have become dangerous, or the undertaking of those acts in compliance with obligations imposed by or under an Act of Parliament or so far as may be necessary for the prevention or abatement of a nuisance. Subsection (7) of that section makes section 198 subject to section 39(2) of the Housing and Planning Act 1986 (c.63) (saving for effect of section 2(4) of the Opencast Act 1967 1958 on land affected by a tree preservation order despite its repeal) and section 15 of the Forestry Act 1967 (c.10) (licences under that Act to fell trees comprised in a tree preservation order).

- (a) cut down, top, lop, uproot, wilfully damage or wilfully destroy; or
- (b) cause or permit the cutting down, topping, lopping, uprooting, wilful damage or wilful destruction of,

any tree specified in Schedule 1 to this Order or comprised in a group of trees or in a woodland so specified, except with the consent of the authority and, where such consent is given subject to conditions, in accordance with those conditions.

Exemptions

5. (1) Nothing in article 4 shall prevent –

- (a) the cutting down, lopping or uprooting of a tree by or at the request of a statutory undertaker, where the land on which the tree is situated is operational land^(d) of the statutory undertaker and the work is necessary –
 - (i) in the interests of the safe operation of the undertaking;
 - (ii) in connection with the inspection, repair or renewal of any sewers, mains, pipes, cables or other apparatus of the statutory undertaker; or
 - (iii) to enable the statutory undertaker to carry out development permitted by or under the Town and Country Planning (General Permitted Development) Order 1995^(a)
- (b) the cutting down, topping, lopping or uprooting of a tree cultivated for the production of fruit in the course of a business or trade where such work is in the interests of that business or trade;
- (c) the pruning in accordance with good horticultural practice, of any tree cultivated for the production of fruit;
- (d) the cutting down, topping, lopping or uprooting of a tree where that work is required to enable a person to implement a planning permission (other than an outline planning permission or, without prejudice to paragraph (a)(iii), a permission granted by or under the Town and Country Planning (General Permitted Development) Order 1995) granted on an application under Part III of the Act, or deemed to have been granted (whether for the purposes of that Part or otherwise);
- (e) the cutting down, topping, lopping or uprooting of a tree by or at the request of the Environment Agency to enable the Agency to carry out development permitted by or under the Town and Country Planning (General Permitted Development) Order 1995.

^(d) See section 263 of the town and Country Planning Act 1990.

^(a) S.I. 1995/418.

- (f) the cutting down, topping, lopping or uprooting of a tree by or at the request of a drainage body where that tree interferes, or is likely to interfere with the exercise of any of the functions of that body in relation to the maintenance, improvement or construction of watercourses or of drainage works, and for this purpose "drainage body" and "drainage" have the same meanings as in the Land Drainage Act 1991^(b); or
- (g) without prejudice to section 198(6)(b), the felling or lopping of a tree or the cutting back of its roots by or at the request of, or in accordance with a notice served by, a licence holder under paragraph 9 of Schedule 4 to the Electricity Act 1989^(c).
- (2) In paragraph (1), "statutory undertaker" means any of the following –
- a person authorised by any enactment to carry on any railway, light railway, tramway, road transport, water transport, canal, inland navigation, dock, harbour, pier or lighthouse undertaking, or any undertaking for the supply of hydraulic power,
 - a relevant airport operator (within the meaning of Part V of the Airports Act 1986)^(d)
 - the holder of a licence under section 6 of the Electricity Act 1989,
 - a public gas transporter,
 - the holder of a licence under section 7 of the Telecommunications Act 1984^(e) to whom the telecommunications code (within the meaning of that Act) is applied.
 - a water or sewerage undertaker,
 - the Civil Aviation Authority or a body acting on behalf of that Authority,
 - the Post Office.

Applications for consent under the Order

6. An application for consent to the cutting down, topping, lopping or uprooting of any tree in respect of which this Order is for the time being in force shall be made in writing to the authority and shall –

- (a) identify the tree or trees to which it relates (if necessary, by reference to a plan);
- (b) specify the work for which consent is sought; and
- (c) contain a statement of the applicant's reasons for making the application.

^(b) 1991 c.59, see section 72.

^(c) 1989 c.29.

^(d) 1986 c.31.

^(e) 1984 c.12.

Application of provisions of the Town and Country Planning Act 1990

7. (1) The provisions of the Town and Country Planning Act 1990 relating to registers, applications, permissions and appeals mentioned in column (1) of Part 1 of Schedule 2 to this Order shall have effect, in relation to consents under this Order and applications for such consent, subject to the adaptations and modifications mentioned in column (2).

(2) The provisions referred to in paragraph (1), as so adapted and modified, are set out in Part II of that Schedule.

Directions as to replanting

8. (1) Where consent is granted under this Order for the felling in the course of forestry operations of any part of a woodland area, the authority may give to the owner of the land on which that part is situated ("the relevant land") a direction in writing specifying the manner in which and the time within which he shall replant the relevant land.

(2) Where a direction is given under paragraph (1) and trees on the relevant land are felled (pursuant to the consent), the owner of that land shall replant it in accordance with the direction.

(3) A direction under paragraph (1) may include requirements as to –

- (a) species;
- (b) number of trees per hectare;
- (c) the preparation of the relevant land prior to the replanting;
and
- (d) the erection of fencing necessary for the protection of the newly planted trees.

Compensation

9. (1) If, on a claim under this article, a person establishes that loss or damage has been caused or incurred in consequence of –

- (a) the refusal of any consent required under this Order; or
- (b) the grant of any such consent subject to conditions,

he shall, subject to paragraphs (3) and (4), be entitled to compensation from the authority.

(2) No claim, other than a claim made under paragraph (3), may be made under this article –

- (a) if more than 12 months have elapsed since the date of the authority's decision or, where such a decision is the subject of an appeal to the Secretary of State, the date of the final determination of the appeal; or

- (b) if the amount in respect of which the claim would otherwise have been made is less than £500.

(3) Where the authority refuse consent under this Order for the felling in the course of forestry operations or any part of a woodland area, they shall not be required to pay compensation to any person other than the owner of the land; and such compensation shall be limited to an amount equal to any depreciation in the value of the trees which is attributable to deterioration in the quality of the timber in consequence of the refusal.

(4) In any other case, no compensation shall be payable to a person –

- (a) for loss of development value or other diminution in the value of the land;
- (b) for loss or damage which, having regard to the statement of reasons submitted in accordance with article 6(c) and any documents or other evidence submitted in support of any such statement, was not reasonably foreseeable when consent was refused or was granted subject to conditions;
- (c) for loss or damage reasonably foreseeable by that person and attributable to his failure to take reasonable steps to avert the loss or damage or to mitigate its extent; or
- (d) for costs incurred in appealing to the Secretary of State against the refusal of any consent required under this Order or the grant of any such consent subject to conditions.

(5) Subsections (3) to (5) of section 11 (terms of compensation on refusal of licence) of the Forestry Act 1967 shall apply to the assessment of compensation under paragraph (3) as it applies to the assessment of compensation where a felling licence is refused under section 10 (application for felling licence and decision of Commissioners thereon) of that Act as if for any reference to a felling licence there were substituted a reference to a consent required under this Order and for the reference to the Commissioners there were substituted a reference to the authority.

(6) In this article –

“development value” means an increase in value attributable to the prospect of development; and, in relation to any land the development of it shall include the clearing of it; and
“owner” has the meaning given to it by section 34 of the Forestry Act 1967.

TREE PRESERVATION ORDER 2005 (No. 403)

LIST OF ALL PEOPLE SERVED WITH ORDER AND NOTICE

The Owner/ Occupier
150, 152, 154 Sycamore Road
Farnborough
Hants GU14 6RF

The Owner/ Occupier
59, 63-87 (odds) 91, 93, 95 Canterbury Road
Farnborough
Hants GU14 6QN

The Owner/ Occupier
1, 2, 3 King George Close
Farnborough
Hants GU14 6PW

The Owner/ Occupier
4-10 Canterbury Gardens
Farnborough
Hants GU14 6ST

HH Hilder & Sons
Sheiling House
Invincible Road
Farnborough
Hants GU14 7OU

Ian Keen
Redlands Farm
Redlands Lane
Ewshot
Farnham
Surrey GU10 5AS

Rushmoor Borough Council
Property Services
Council Offices
Farnborough Road
Farnborough
Hants GU14 7JU

Knellwood Ward Councillors: R Dibbs, P Kirby, P Taylor

TREE PRESERVATION ORDER: 403

Trees within the grounds of Knellwood, Canterbury Road, Canterbury Gardens, King George Close & 152 Sycamore Road, Farnborough, Hampshire, 2005.

It is expedient in the interest of amenity to make provision for the preservation of trees on the above site and that a Tree Preservation Order should be issued in respect of the above site.

Signed 

Head of Planning Services

Dated: 7.10.05

Agreed

Signed 

Solicitor to the Council

Dated: 10/10/05

Dated

10th day of October 2005

The Common Seal of *Rushmoor Borough Council*
was hereunto affixed in the presence of –

333/05



.....
Leader of the Council or appropriate Council Member.



.....
Solicitor to the Council

SCHEDULE 1

Article 4

SPECIFICATION OF TREES

Trees specified individually
(encircled in black on the map)

Reference on map	Description	Situation
T1	Cedar	Knellwood
T2	Beech	Adj. Knellwood
T3	Oak	Adj. Knellwood
T4	Oak	Adj. Knellwood
T5	Oak	Adj. Knellwood
T6	Oak	Adj. Knellwood
T7	Oak	Adj. Knellwood
T8	Oak	Adj. Knellwood
T9	Oak	Adj. Knellwood
T10	Oak	Adj. Knellwood
T11	Oak	Adj. Knellwood
T12	Oak	Adj. Knellwood
T13	Oak	Adj. Knellwood
T14	Oak	Adj. Knellwood
T15	Oak	Adj. Knellwood
T16	Oak	Adj. Knellwood
T17	Oak	Adj. Knellwood
T18	Oak	Adj. Knellwood
T19	Oak	Adj. Knellwood
T20	Beech	Knellwood
T21	Horse Chestnut	Knellwood
T22	Horse Chestnut	Knellwood
T23	Sycamore	Adj. 81 Canterbury Road
T24	False Acacia	Adj. 81 Canterbury Road
T25	Oak	Adj. 81 Canterbury Road
T26	Oak	Adj. 81 Canterbury Road
T27	Sycamore	Adj. 81 Canterbury Road
T28	Oak	Adj. 81 Canterbury Road
T29	Oak	Adj. 81 Canterbury Road
T30	Sycamore	Adj. 85 Canterbury Road
T31	Oak	Adj. 85 Canterbury Road
T32	Monkey Puzzle	Adj. 3 King George Close
T33	Oak	Adj. Knellwood
T34	Birch	2 King George Close
T35	Monkey Puzzle	1 King George Close
T36	Birch	Adj. Knellwood
T37	Ash	Adj. Knellwood
T38	Sycamore	Adj. Knellwood
T39	Sycamore	Adj. Knellwood
T40	Norway Maple	Adj. Knellwood
T41	Oak	King George Close
T42	Oak	King George Close

T43	Scots Pine	Canterbury Gardens
T44	Oak	Canterbury Gardens
T45	Scots Pine	Adj. Canterbury Gardens
T46	Beech	Adj. Canterbury Gardens
T47	Oak	Adj. Canterbury Gardens
T48	Norway Maple	Adj. Canterbury Gardens
T49	Oak	Adj. Canterbury Gardens
T50	Beech	Adj. Canterbury Gardens
T51	Fir	Adj. Canterbury Gardens
T52	Oak	Adj. Canterbury Gardens
T53	Beech	Adj. Canterbury Gardens
T54	Oak	Adj. Canterbury Gardens
T55	Beech	Adj. Canterbury Gardens

Trees specified by reference to an area
(within a dotted black line on the map)

Reference on map	Description	Situation
	NONE	

Groups of trees
(within a broken line on the map)

Reference on map	Description (including number of trees in the group)	Situation
G1	Oak x 10 Norway Maple x 7 Sycamore x 4 False Acacia x1 Hornbeam x 1	Adj. Knellwood
G2	Oak x 16 Sycamore x 8	152 Sycamore Road

Woodlands
(within a continuous black line on the map)

Reference on map	Description	Situation
	NONE	

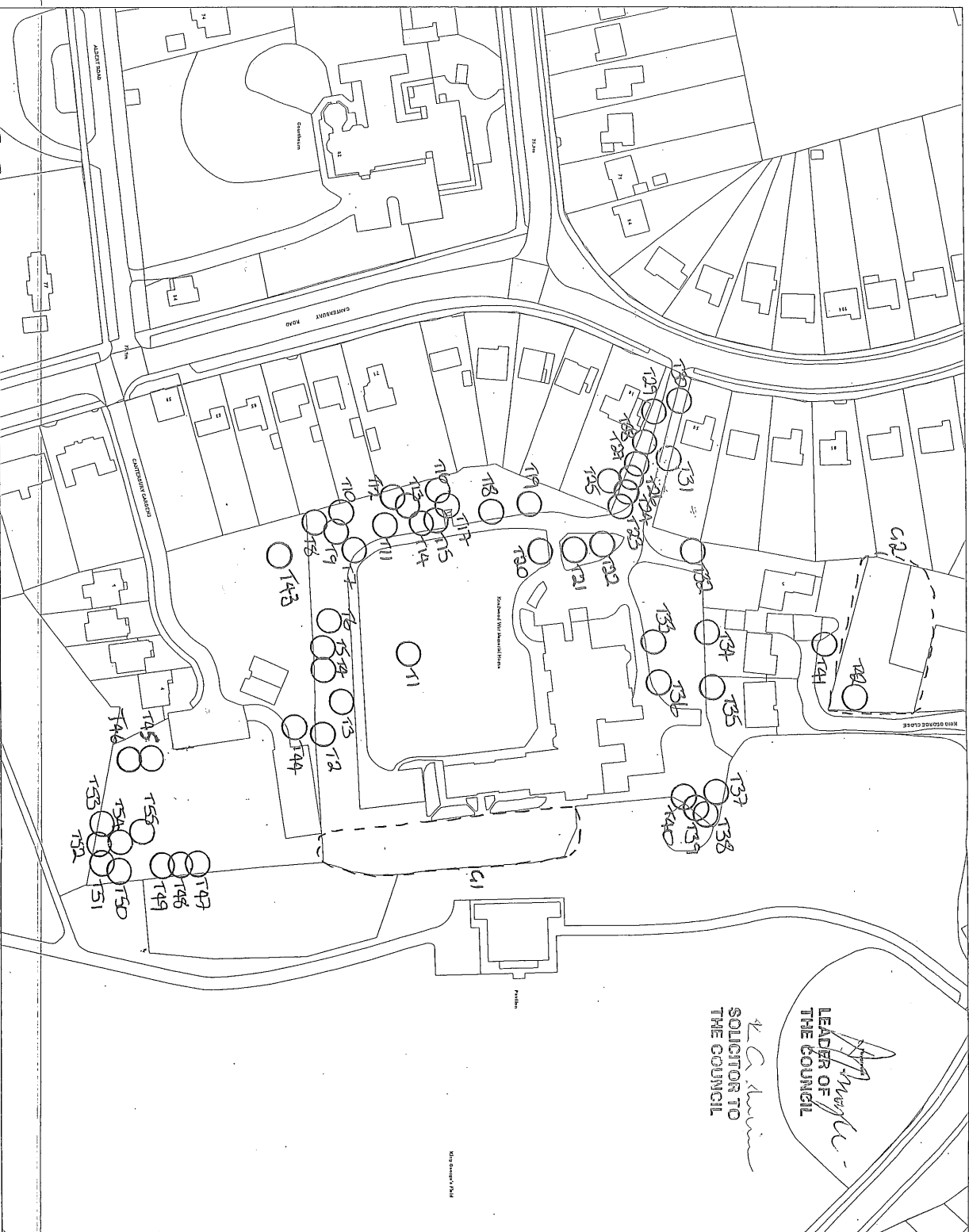

RUSHMOOR BOROUGH COUNCIL

DIRECTORATE OF ENVIRONMENTAL SERVICES

KEITH HOLLAND, BA, MRTPI
HEAD OF PLANNING SERVICES
COUNCIL OFFICES
FARNBOROUGH ROAD, FARNBOROUGH
HANTS, GU14 7JU
TEL: (01252) 398398

TREE PRESERVATION ORDER No 403

TREE SCHEDULE: Please refer to schedule 1

T1-T55 INDIVIDUAL TREES
G1-G2 GROUPS OF TREES

Location: -

Trees within the grounds of
Kneilwood, Canterbury Road, Canterbury Gardens,
King George Close & 152 Sycamore Road
Farnborough
Hampshire

Date: 13/09/2005 Map Reference: E.487785 N.154776
Scale: 1:1250

Controller HMSO (copyright).
Licence No 100024264 Crown Copyright reserved
Unauthorised reproduction infringes Crown Copyright (2003)
and may lead to prosecution or civil proceedings

SCHEDULE 1

Article 4

SPECIFICATION OF TREES

Trees specified individually (encircled in black on the map)

Reference on map	Description	Situation
T1	Cedar	Knellwood
T2	Beech	Knellwood
T3	Oak	Knellwood
T4	Oak	Knellwood
T5	Oak	Knellwood
T6	Oak	Knellwood
T7	Oak	Knellwood
T8	Oak	Knellwood
T9	Oak	Knellwood
T10	Oak	Knellwood
T11	Oak	Knellwood
T12	Oak	Knellwood
T13	Oak	Knellwood
T14	Oak	Knellwood
T15	Oak	Knellwood
T16	Oak	Knellwood
T17	Oak	Knellwood
T18	Oak	Knellwood
T19	Oak	Knellwood
T20	Beech	Knellwood
T21	Horse Chestnut	Knellwood
T22	Horse Chestnut	Knellwood
T23	Sycamore	Adj. 81 Canterbury Road
T24	False Acacia	Adj. 81 Canterbury Road
T25	Oak	Adj. 81 Canterbury Road
T26	Oak	Adj. 81 Canterbury Road
T27	Sycamore	Adj. 81 Canterbury Road
T28	Oak	Adj. 81 Canterbury Road
T29	Oak	Adj. 81 Canterbury Road
T30	Sycamore	Adj. 85 Canterbury Road
T31	Oak	Adj. 85 Canterbury Road
T32	Monkey Puzzle	Adj. 3 King George Close
T33	Oak	Knellwood
T34	Birch	2 King George Close
T35	Monkey Puzzle	1 King George Close
T36	Birch	Knellwood
T37	Ash	Knellwood
T38	Sycamore	Knellwood
T39	Sycamore	Knellwood
T40	Norway Maple	Knellwood
T41	Oak	King George Close
T42	Oak	King George Close

T43	Scots Pine	7	Canterbury Gardens
T44	Oak	Record of 5	Canterbury Gardens
T45	Scots Pine		Canterbury Gardens
T46	Beech		Canterbury Gardens
T47	Oak		Canterbury Gardens
T48	Norway Maple		Canterbury Gardens
T49	Oak		Canterbury Gardens
T50	Beech		Canterbury Gardens
T51	Fir		Canterbury Gardens
T52	Oak		Canterbury Gardens
T53	Beech		Canterbury Gardens
T54	Oak		Canterbury Gardens
T55	Beech		Canterbury Gardens

Trees specified by reference to an area
(within a dotted black line on the map)

Reference on map	Description	Situation
	NONE	

Groups of trees
(within a broken line on the map)

Reference on map	Description (including number of trees in the group)	Situation
G1	Oak x 10 Norway Maple x 7 Sycamore x 4 False Acacia x1 Hornbeam x 1	Knellwood
G2	Oak x 16 Sycamore x 8	152 Sycamore Road

Woodlands
(within a continuous black line on the map)

Reference on map	Description	Situation
	NONE	

**TOWN AND COUNTRY PLANNING ACT 1990 (SECTION 199)
TOWN AND COUNTRY PLANNING (TREES) REGULATIONS 1999**

RUSHMOOR BOROUGH COUNCIL

TPO 403

**Trees within the grounds of Knellwood, Canterbury Road,
Canterbury Gardens, King George Close & 152 Sycamore Road,
Farnborough, Hampshire, 2005.**

Under the provisions of Section 199 of the Town and Country Planning Act 1990 and the Town and Country Planning (Trees) Regulations 1999, Rushmoor Borough Council having considered two representations received in respect of the above Tree Preservation Order, this Order is hereby confirmed without modification other than to record the correction of typographical errors within Schedule 1 of the Order.

Signed..........

Head of Planning Services

Dated.....27.2.06.....

AGREED

Signed..........

Solicitor to the Council

Dated.....7/3/06.....

CONFIRMATION OF ORDER 403

This Order was confirmed by Rushmoor Borough Council without modification:

Other than to record the omission of the word 'Adj' from the location of some of the trees within Schedule 1 of the Order.

on the 7th day of March, 2006

62/06

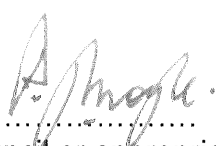
.....
Leader of the Council or appropriate Council Member

.....
Solicitor to the Council

TPO_403 pack

Final Audit Report

2022-07-19

Created:	2022-07-19
By:	Toby Fotheringham (toby.fotheringham@rushmoor.gov.uk)
Status:	Signed
Transaction ID:	CBJCHBCAABAApBnncXP55HIHxJeMTYO3jfPtfSFHxCpD

"TPO_403 pack" History

 Document created by Toby Fotheringham (toby.fotheringham@rushmoor.gov.uk)
2022-07-19 - 11:52:59 AM GMT

 Document emailed to tim.mills@rushmoor.gov.uk for signature
2022-07-19 - 11:53:42 AM GMT

 Email viewed by tim.mills@rushmoor.gov.uk
2022-07-19 - 2:15:32 PM GMT

 Document e-signed by Tim Mills (tim.mills@rushmoor.gov.uk)
Signature Date: 2022-07-19 - 2:15:55 PM GMT - Time Source: server

 Agreement completed.
2022-07-19 - 2:15:55 PM GMT