

# **Town and Country Planning Act 1990**

## **Tree Preservation Order 23/00484/ORDER**

### **Trees within Land Affected By TPO 484 At Fernhill Road Lockwood Close And, Linstead Road, Farnborough, Hampshire. [2022]**

Rushmoor Borough Council, in exercise of the powers conferred on them by section 198 of the Town and Country Planning Act 1990 make the following Order—

#### **Citation**

1. This Order may be cited as Trees within Land Affected By TPO 484 At Fernhill Road Lockwood Close And, Linstead Road, Farnborough, Hampshire. [2022]

#### **Interpretation**

2.— (1) In this Order “the authority” means Rushmoor Borough Council.

(2) In this Order any reference to a numbered section is a reference to the section so numbered in the Town and Country Planning Act 1990 and any reference to a numbered regulation is a reference to the regulation so numbered in the Town and Country Planning (Tree Preservation) (England) Regulations 2012.

#### **Effect**

3.— (1) Subject to article 4, this Order takes effect provisionally on the date on which it is made.

(2) Without prejudice to subsection (7) of section 198 (power to make tree preservation orders) or subsection (1) of section 200 (tree preservation orders: Forestry Commissioners) and, subject to the exceptions in regulation 14, no person shall—

(a) cut down, top, lop, uproot, wilfully damage, or wilfully destroy; or

(b) cause or permit the cutting down, topping, lopping, wilful damage or wilful destruction of, any tree specified in the Schedule to this Order except with the written consent of the authority in accordance with regulations 16 and 17, or of the Secretary of State in accordance with regulation 23, and, where such consent is given subject to conditions, in accordance with those conditions.

#### **Application to trees to be planted pursuant to a condition**

4. In relation to any tree identified in the first column of the Schedule by the letter “C”, being a tree to be planted pursuant to a condition imposed under paragraph (a) of section 197 (planning permission to include appropriate provision for preservation and planting of trees), this Order takes effect as from the time when the tree is planted.

## **Tree Preservation Order: 23/00484/ORDER**

**Trees within Land Affected By TPO 484 At Fernhill Road Lockwood  
Close And, Linstead Road, Farnborough, Hampshire. [2022]**

Dated this Sep 19, 2023

Signed on behalf of Rushmoor Borough Council by

*Tim Mills*

Tim Mills (Sep 19, 2023 12:35 GMT+1)

Executive Head of Property and Growth

Authorised by the Council to Sign in that behalf

## CONFIRMATION OF ORDER

This Order was confirmed by Rushmoor Borough Council without modification on the

*OR*

This Order was confirmed by Rushmoor Borough Council, subject to the modifications indicated on the attached schedule in **bold text**, on the

Signed on behalf of Rushmoor Borough Council by

.....

Executive Head of Property and Growth

Authorised by the Council to Sign in that behalf

Tree Schedule: Please refer to Schedule 1

*Tim Mills*  
Tim Mills (Sep 19, 2023 12:35 GMT+1)

Date: 16/08/2023

Scale: 1:1,250

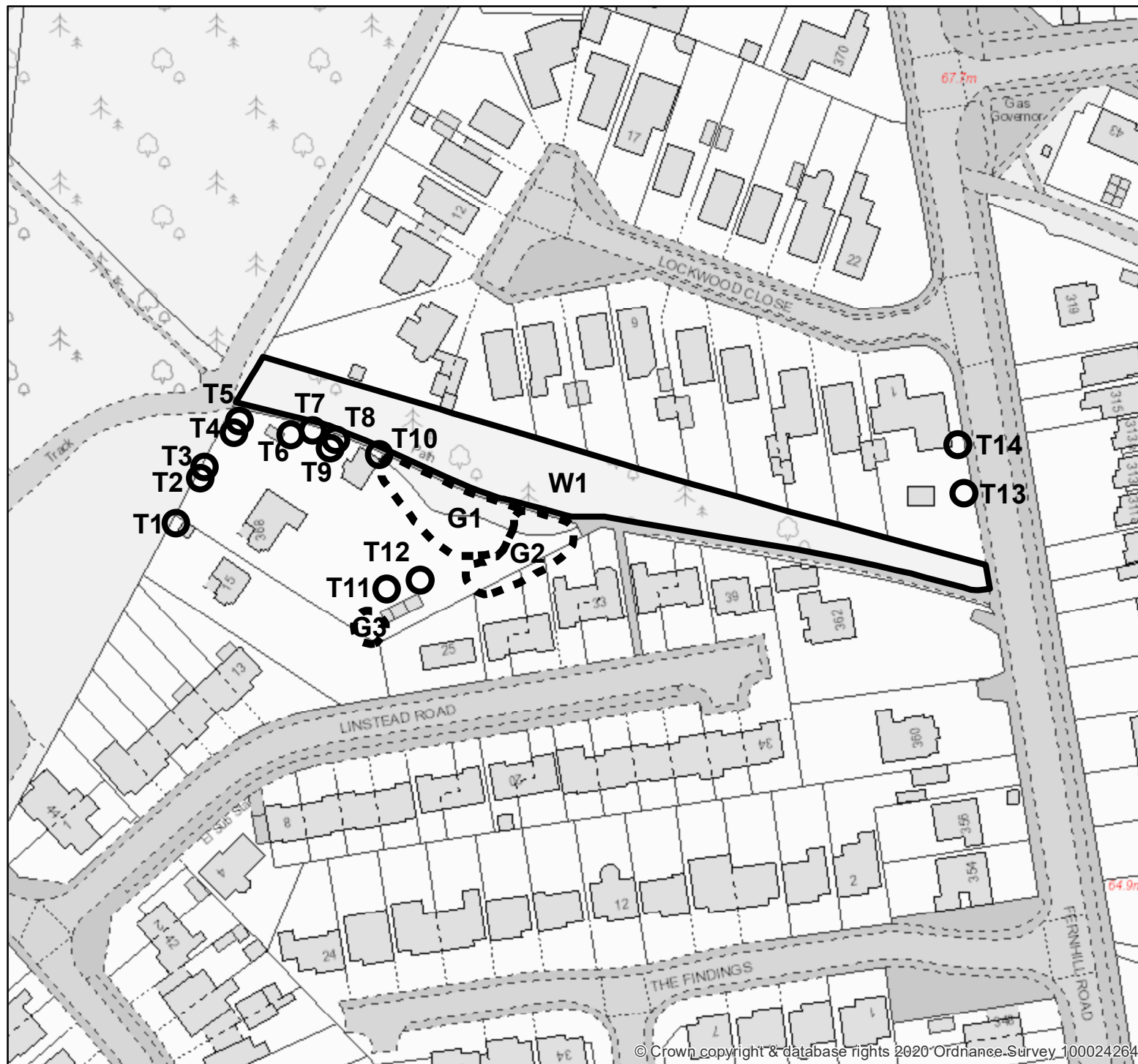
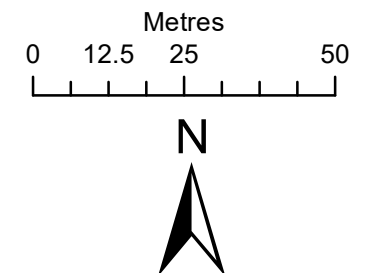

## Schedule

### Specification of trees

#### Trees specified individually

(Encircled in black on the map)

<i>Reference on map</i>	<i>Description</i>	<i>Situation</i>
T1	Oak	Winding Way 15 Linstead Road
T2	Birch	368 Fernhill Road
T3	Oak	368 Fernhill Road
T4	Birch	368 Fernhill Road
T5	Birch	368 Fernhill Road
T6	Beech	368 Fernhill Road
T7	Oak	368 Fernhill Road
T8	Oak	368 Fernhill Road
T9	Oak	368 Fernhill Road
T10	Pine	368 Fernhill Road
T11	Beech	368 Fernhill Road
T12	Oak	368 Fernhill Road
T13	Oak	1 Lockwood Close
T14	Oak	1 Lockwood Close

#### Groups of trees

(within a broken black line on the map)

<i>Reference on map</i>	<i>Description</i>	<i>Situation</i>
G1	7 Oaks	368 Fernhill Road
G2	12 Pines	368 Fernhill Road and Rear of 27-31 Linstead Road
G3	1 Birch 1 Oak 1 Pine	368 Fernhill Road

#### Woodlands

(within a continuous black line on the map)

<i>Reference on map</i>	<i>Description</i>	<i>Situation</i>
W1	Contains Beeches, Birches, Hazels, Hornbeams, Horse Chestnuts, Oaks, Poplars, and Pines,	Land Adjacent to 362 Fernhill Road & 368 Fernhill Road and to the rear of 1-10 Lockwood Close & 33-39 Linstead Road

**Tree Preservation Order 23/00484/ORDER**  
**List of all People Served with Order and Notice**

Winding Way  
15 Linstead Road  
Farnborough  
Hampshire  
GU14 9HH

39 Linstead Road  
Farnborough  
Hampshire  
GU14 9HH

8 Lockwood Close  
Farnborough  
Hampshire  
GU14 9EH

25 Linstead Road  
Farnborough  
Hampshire  
GU14 9HH

1 Lockwood Close  
Farnborough  
Hampshire  
GU14 9EH

9 Lockwood Close  
Farnborough  
Hampshire  
GU14 9EH

27 Linstead Road  
Farnborough  
Hampshire  
GU14 9HH

2 Lockwood Close  
Farnborough  
Hampshire  
GU14 9EH

10 Lockwood Close  
Farnborough  
Hampshire  
GU14 9EH

29 Linstead Road  
Farnborough  
Hampshire  
GU14 9HH

3 Lockwood Close  
Farnborough  
Hampshire  
GU14 9EH

368 Fernhill Road  
Farnborough  
Hampshire  
GU14 9EF

31 Linstead Road  
Farnborough  
Hampshire  
GU14 9HH

4 Lockwood Close  
Farnborough  
Hampshire  
GU14 9EH

362 Fernhill Road  
Farnborough  
Hampshire  
GU14 9EF

33 Linstead Road  
Farnborough  
Hampshire  
GU14 9HH

5 Lockwood Close  
Farnborough  
Hampshire  
GU14 9EH

Andy Ford (Internal)

35 Linstead Road  
Farnborough  
Hampshire  
GU14 9HH

6 Lockwood Close  
Farnborough  
Hampshire  
GU14 9EH

**Councillors:**  
Cllr Jessica Auton  
Cllr Akmal Gani  
Cllr Abe Allen

37 Linstead Road  
Farnborough  
Hampshire  
GU14 9HH

7 Lockwood Close  
Farnborough  
Hampshire  
GU14 9EH







# TPO Order

Final Audit Report

2023-09-19

Created:	2023-09-19
By:	Karen Campbell-Fotheringham (karen.campbell@rushmoor.gov.uk)
Status:	Signed
Transaction ID:	CBJCHBCAABAAkFoeO4yeGRYLtCUEiGIJ-spE66D7iYc

## "TPO Order" History

-  Document created by Karen Campbell-Fotheringham (karen.campbell@rushmoor.gov.uk)  
2023-09-19 - 9:32:12 AM GMT- IP address: 62.254.233.188
-  Document emailed to tim.mills@rushmoor.gov.uk for signature  
2023-09-19 - 9:33:56 AM GMT
-  Email viewed by tim.mills@rushmoor.gov.uk  
2023-09-19 - 11:34:34 AM GMT- IP address: 104.47.85.62
-  Signer tim.mills@rushmoor.gov.uk entered name at signing as Tim Mills  
2023-09-19 - 11:35:12 AM GMT- IP address: 62.254.233.188
-  Document e-signed by Tim Mills (tim.mills@rushmoor.gov.uk)  
Signature Date: 2023-09-19 - 11:35:14 AM GMT - Time Source: server- IP address: 62.254.233.188
-  Agreement completed.  
2023-09-19 - 11:35:14 AM GMT